

LAYOUT NOTES:

1. ALL LINE AND GRADE INFORMATION SHALL BE LAID OUT BY A NEW YORK STATE REGISTERED SURVEYOR ENGAGED BY THE CONTRACTOR.
2. ALL NEW WORK SHALL BE STAKED OUT PRIOR TO CONSTRUCTION. THE OWNER'S REPRESENTATIVE SHALL BE NOTIFIED OF ANY DISCREPANCIES. FIELD ADJUSTMENTS MUST BE APPROVED BY THE OWNER'S REPRESENTATIVE PRIOR TO CONSTRUCTION.
3. ALL LINES AND DIMENSIONS ARE PARALLEL OR PERPENDICULAR TO THE LINES FROM WHICH THEY ARE MEASURED UNLESS OTHERWISE NOTED.
4. DIMENSIONS TO CURBS ARE FROM FACE OR BOTTOM OF CURB TO FACE OR BOTTOM OF CURB.
5. FIELD ADJUSTMENTS MUST BE APPROVED BY THE OWNER'S REPRESENTATIVE AND IF NECESSARY APPROPRIATE MUNICIPAL OFFICIALS.
6. ALL LAYOUTS FOR WALKS AND PATHS SHALL BE ADEQUATELY STAKED BY THE CONTRACTOR AND APPROVED BY THE OWNER'S REPRESENTATIVE PRIOR TO CONSTRUCTION.
7. ALL PROPOSED WALKS, PAVEMENTS, LIGHTS AND SITE IMPROVEMENTS SHALL BE STAKED IN THE FIELD FOR APPROVAL BY THE OWNER'S REPRESENTATIVE PRIOR TO CONSTRUCTION.
8. CONTRACTOR SHALL COORDINATE LOCATION OF ALL UTILITIES (LINES, DUCTS, CONDUITS, SLEEVES, FOOTINGS, ETC.) WITH LOCATIONS OF PROPOSED LANDSCAPE ELEMENTS (WALLS, FENCE, FOOTINGS, TREE ROOTBALLS, PROPOSED LIGHTING FOOTINGS, ETC.). CONTRACTOR SHALL REPORT ANY DISCREPANCIES TO OWNER'S REPRESENTATIVE PRIOR TO CONTINUING WORK.

Unauthorized alteration or addition to this document is a violation of Section 7209 of the New York State Education Law.

© The LA Group 2017

Prepared for:
Kodiak Construction, INC.
 740 Route 9 Wilton, NY 12831

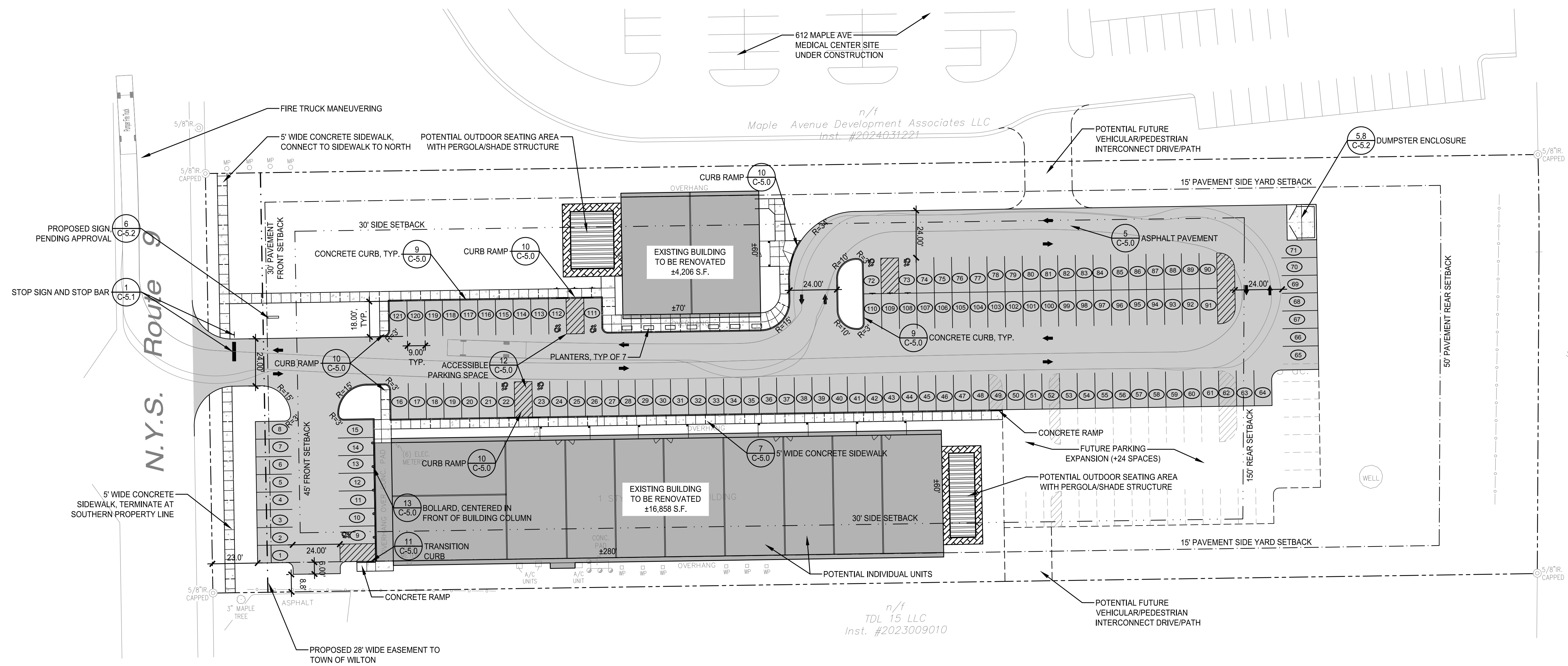

LEGEND

- PROPERTY LINE
- SETBACK LINE
- 6" CONCRETE CURB
- ASPHALT PAVEMENT
- CONCRETE PAVEMENT
- ⊕ SIGNAGE

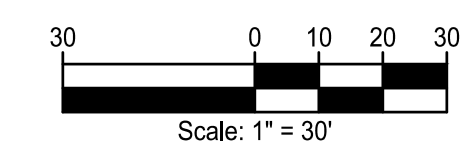

Project Title:
610 Maple Ave Redevelopment

610 Maple Ave, Wilton NY 12866

Project No.: 2025067
 Design: DBH
 Drawn: MLD Ch'k'd: DBH
 Date: 02/03/26 Scale: 1"=30'

| Rev. | Description: | Date: |
|------|--------------|----------|
| 1 | PB Comments | 03/02/26 |
| | | |
| | | |
| | | |

Drawing Title:
LAYOUT AND MATERIALS PLAN

Drawing No.:
C-2.0